

Bartram & Co



35 Berrywood Drive, Northampton, NN5 6GA

£1,350 Per Calendar Month -

 3  2  1  C
Council Tax Band: D Service Charge: x Ground Rent: x



£1,350 Per Calendar Month

35 Berrywood Drive

Northampton, NN5 6GA

- Lounge/Dining Room, Kitchen
- Three Double Bedrooms
- Built-in Wardrobes, Storage
- Available 1st December
- EPC Energy Rating: C
- Downstairs W.C.. Bathroom
- En-suite Shower Room
- Single Garage, Gardens
- Council Tax Band: D
- Holding Payment: £311.00

A good-sized townhouse close to local amenities and schooling. The accommodation is across three floors and offers a front-to-rear lounge/dining room, fitted kitchen, downstairs WC, family bathroom, three double bedrooms, and an en-suite shower. To the front is a small garden with a fully enclosed rear garden providing pedestrian access to the single garage.

N.B.: This property is currently undergoing redecoration.



Hall/Stairs/Landing

Lounge/Dining Room 25'9" x 11'2" (7.856 x 3.407)

Kitchen 12'0" x 6'11" (3.673 x 2.121)

Downstairs Cloakroom 5'5" x 6'7" (1.665 x 2.014)

Bedroom Two 9'4" x 10'9" (2.849 x 3.297)

Bedroom Three 7'6" x 11'6" (2.308 x 3.530)

Bathroom 5'11" x 6'8" (1.822 x 2.056)

Bedroom One 14'8" max x 10'2" (4.484 max x 3.112)

En-suite Shower Room 8'7" x 3'7" (2.622 x 1.093)

Front Garden

Rear Garden

Single Garage

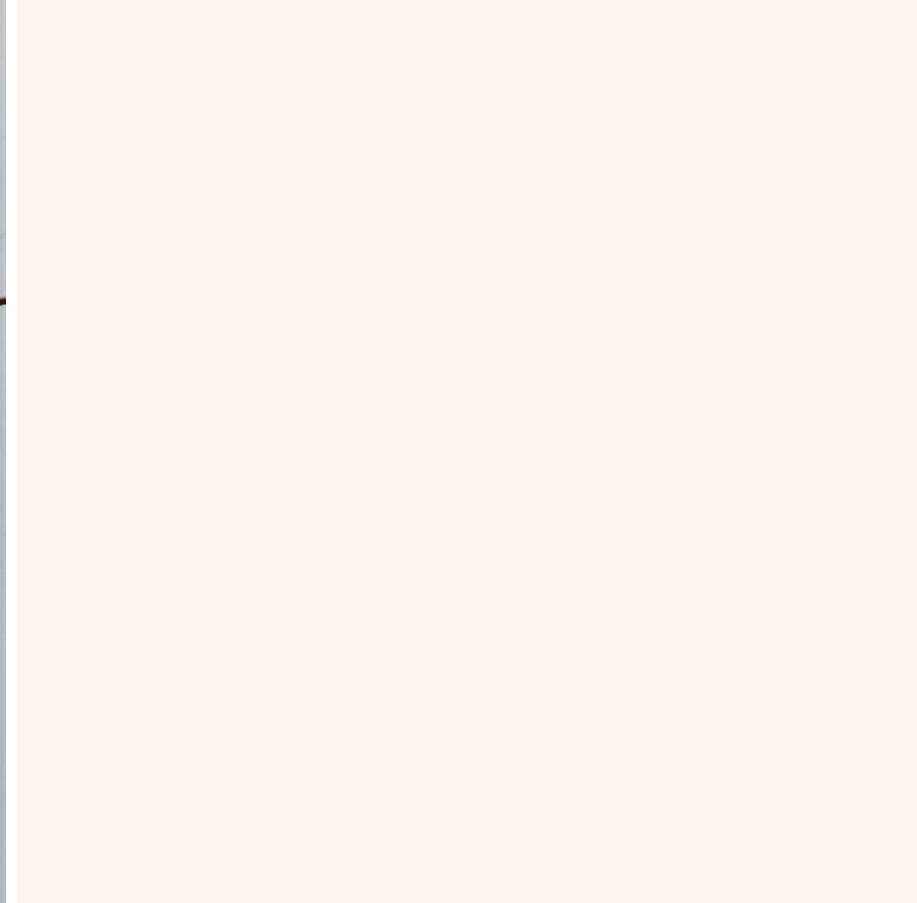

Directions





Floor Plans

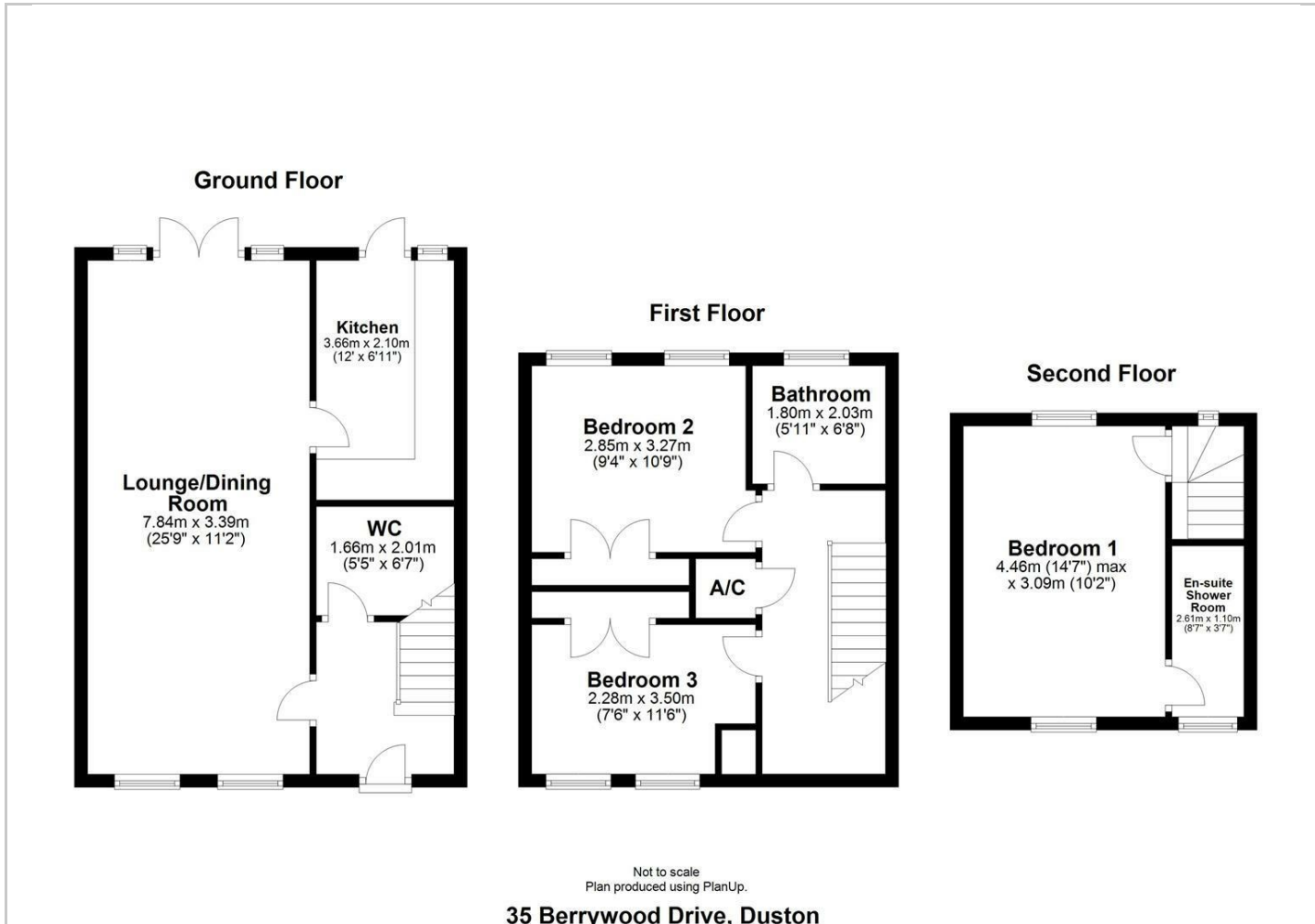

Location Map

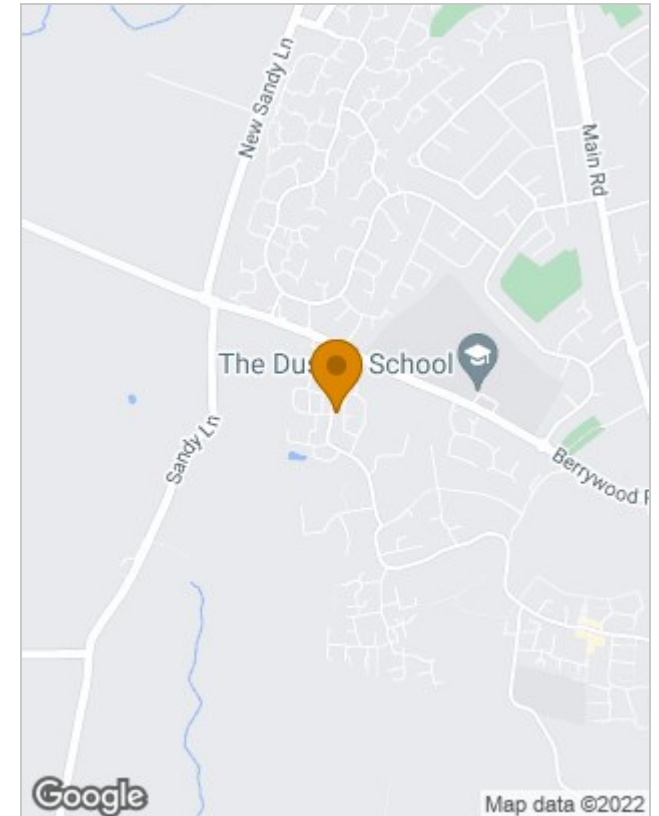

Energy Performance Graph

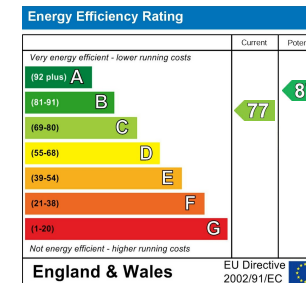

Viewing

Please contact our Towcester Lettings Office on 01327359164 if you wish to arrange a viewing appointment for this property or require further information.

The particulars are set out as a general outline only for the guidance of intended purchasers or lessees, and do not constitute, any part of a contract. Nothing in these particulars shall be deemed to be a statement that the property is in good structural condition or otherwise nor that any of the services, appliances, equipment or facilities are in good working order. Purchasers should satisfy themselves of this prior to purchasing.